

WestConnex is part of the Australian and NSW governments' vision for supporting Sydney's growing population and keeping our economy strong. The M4-M5 Link is the third stage of WestConnex. It will link the New M4 Motorway at Haberfield to the New M5 Motorway at St Peters, with additional connections to the Iron Cove Bridge and Rozelle Interchange.

Construction sites and programs

We have identified and assessed two options for the location of temporary construction support facilities around Haberfield/Ashfield.

The preferred option would be determined during detailed design. It would meet the environmental performance outcomes stated in the EIS and the Submissions and Preferred Infrastructure Report and satisfy criteria that would be identified in any relevant conditions of approval.

Option A

- Wattle Street civil and tunnel site
- Haberfield civil and tunnel site
- Northcote Street civil site

Option B

- Parramatta Road West civil and tunnel site
- Haberfield civil site
- Parramatta Road East civil site

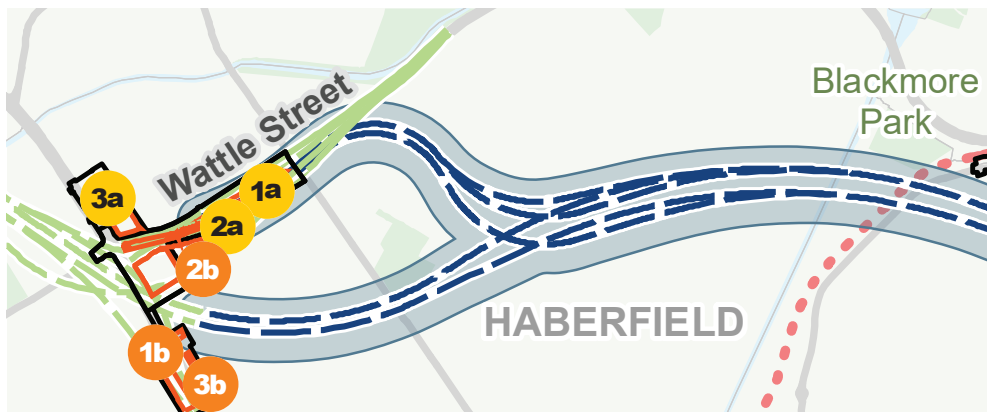
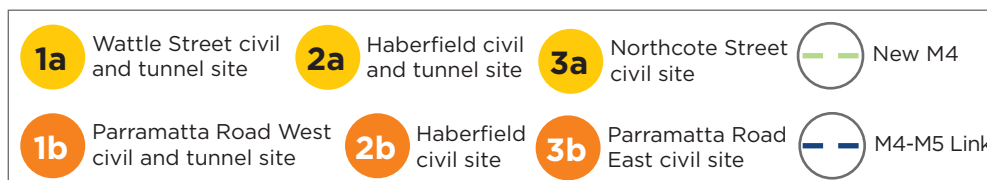

Figure 1. Haberfield/Ashfield site locations



Australian Government

BUILDING OUR FUTURE



Keeping you informed

We are committed to keeping you informed and will provide regular information on the M4-M5 Link through direct mail and email notifications, community updates, local papers and face-to-face activities.

You can also contact the WestConnex info line on **1800 660 248**, email info@westconnex.com.au or visit westconnex.com.au/m4-m5link for more information.

We speak your language



Need an interpreter? Call the Translating and Interpreting Service on **131 450**.

ARABIC

بحاجة إلى مترجم؟ اتصل بخدمة الترجمة الكتابية والترجمة الشفوية على الرقم **131450**.

CHINESE

如需翻译，请拨打翻译与口译热线**131 450**。

GREEK

Χρειάζεστε διερμηνέα; Καλέστε την Υπηρεσία Μεταφραστών και Διερμηνέων στο **131 450**.

VIETNAMESE

Cần thông dịch viên? Hãy điện thoại cho Dịch vụ Thông Phiên Dịch ở số **131 450**.

ITALIAN

Hai bisogno di un interprete? Chiama il servizio al numero **131 450**. d'interpretazione e traduzione

Option A

Wattle Street civil and tunnel site

The Wattle Street civil and tunnel site would be located along Wattle Street in Haberfield, between Parramatta Road and Ramsay Street, on land that is currently being used for construction of the New M4.

The site would support the key construction activities outlined in Figure 2.

Roadheaders would be launched underground from this site to excavate the tunnels that would connect the Wattle Street interchange entry and exit ramps with the M4-M5 Link mainline tunnels.

Construction activity	Indicative construction timeframe															
	2019				2020				2021				2022			
	Q1	Q2	Q3	Q4	Q1	Q2	Q3	Q4	Q1	Q2	Q3	Q4	Q1	Q2	Q3	Q4
Initial road works and traffic management																
Site establishment and utility works																
Below ground site set-up																
Tunnelling																
Civil and mechanical fitout																
Testing and commissioning																
Site rehabilitation and landscaping																

Figure 2. Wattle Street civil and tunnel site indicative construction program

Access routes

Light vehicles would enter and exit the site to and from the eastbound Wattle Street carriageway. Heavy vehicles would enter the site via the eastbound entry ramp, be loaded with excavated material within the tunnels, and then exit the site to Wattle Street via the westbound exit ramp.

Vehicle movements

Location	Daily vehicles (one way)		AM peak hour (7:30am - 8:30am)				PM peak hour (4:15pm - 5:15pm)			
	Heavy vehicles	Light vehicles	Heavy vehicles		Light vehicles		Heavy vehicles		Light vehicles	
Wattle street civil and tunnel site	133	50	Arrive 7	Depart 7	Arrive 10	Depart N/A	Arrive 7	Depart 7	Arrive N/A	Depart 50

Figure 3. Indicative construction vehicle movements at Wattle Street civil and tunnel site

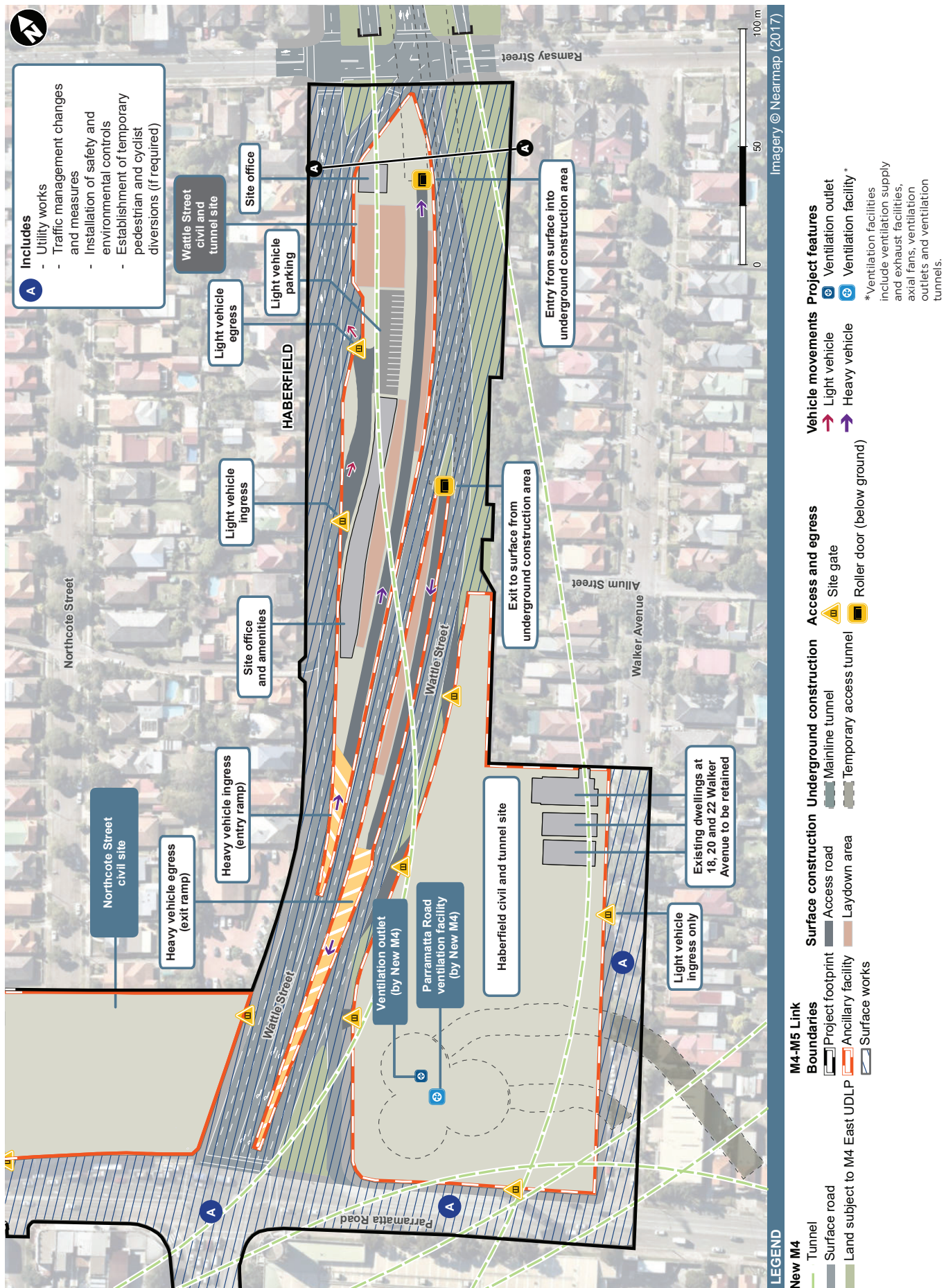

Figure 4. Indicative Wattle Street civil and tunnel site layout

Haberfield civil and tunnel site

The Haberfield civil and tunnel site would be located near the south-eastern corner of the Parramatta Road and Wattle Street intersection, extending along Parramatta Road between Wattle Street and Walker Avenue at Haberfield.

Key construction activities that would take place are outlined in Figure 5.

Roadheaders would be launched from this site to excavate the mainline tunnels. Tunnel spoil would be stockpiled within the New M4 tunnel stubs, and removed via the New M4 tunnels. Surface works would include construction of a substation and fitout of a section of the Parramatta Road ventilation facility (being built as part of the New M4 project).

Construction activity	Indicative construction timeframe															
	2019				2020				2021				2022			
	Q1	Q2	Q3	Q4	Q1	Q2	Q3	Q4	Q1	Q2	Q3	Q4	Q1	Q2	Q3	Q4
Initial road works and traffic management																
Site establishment																
Below ground site set-up																
Establish temporary ventilation systems to be used during construction																
Fitout of ventilation facility and substation																
Tunnelling																
Civil and mechanical fitout																
Testing and commissioning																
Site rehabilitation and landscaping																

Figure 5. Haberfield civil and tunnel site indicative construction program

Access routes

Heavy vehicles would enter the eastbound stub tunnel from the New M4 mainline tunnels and exit to the westbound New M4 mainline tunnels. No tunnel spoil would be removed to the surface via the Haberfield civil and tunnel site.

Heavy vehicles delivering materials and equipment would enter and exit the site via the westbound Wattle Street carriageways. Light vehicles would enter and exit the site via Wattle Street, Walker Avenue and Parramatta Road.

Vehicle movements

Location	Daily vehicles (one way)		AM peak hour (7:30am - 8:30am)				PM peak hour (4:15pm - 5:15pm)			
	Heavy vehicles	Light vehicles	Heavy vehicles		Light vehicles		Heavy vehicles		Light vehicles	
Haberfield civil and tunnel site	136	90	Arrive 7	Depart 7	Arrive 30	Depart N/A	Arrive 7	Depart 7	Arrive N/A	Depart 90

Figure 6. Indicative construction vehicle movements at Haberfield civil and tunnel site

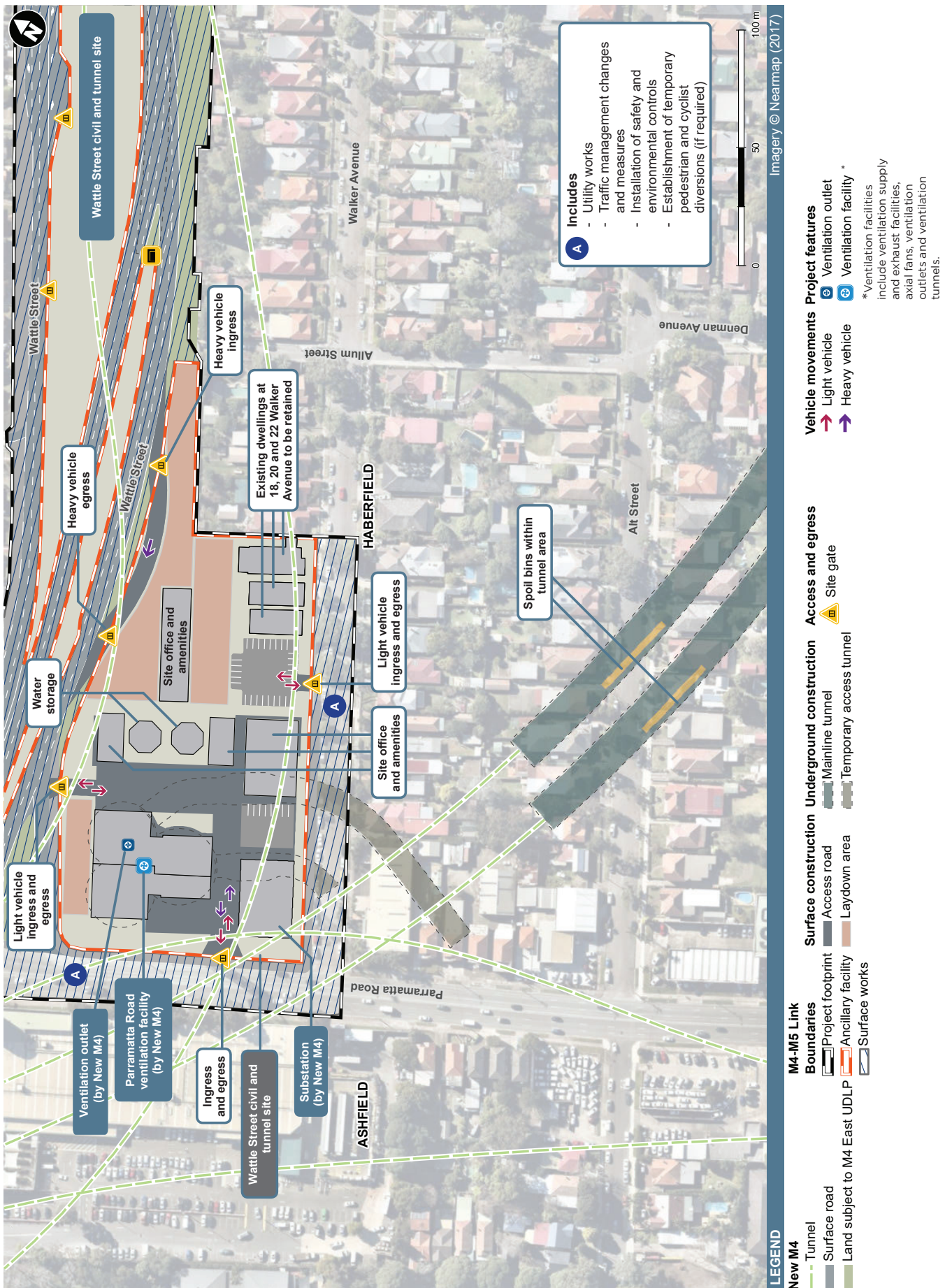

Figure 7. Indicative Haberfield civil and tunnel site layout

Northcote Street civil site

The site at Haberfield is located between Wattle Street and Wolseley Street, on land that currently houses a construction support facility for the New M4 project. The site would be used for construction workforce parking and to support construction activities at the nearby civil and tunnel sites. Around 150 car-parking spaces would be established on this site.

Construction activities that would take place at this site are outlined in Figure 8.

Construction activity	Indicative construction timeframe															
	2019				2020				2021				2022			
	Q1	Q2	Q3	Q4	Q1	Q2	Q3	Q4	Q1	Q2	Q3	Q4	Q1	Q2	Q3	Q4
Site establishment and utility works																
Construct car park																
Construct laydown area																
Operation of car park and laydown area																
Site rehabilitation and landscaping																

Figure 8. Northcote Street civil site indicative construction program

Access routes

Heavy vehicles would enter and exit the site to and from Parramatta Road. Light vehicles would enter the site via Wolseley Street and depart onto Wattle Street.

Vehicle movements

Location	Daily vehicles (one way)		AM peak hour (7:30am - 8:30am)				PM peak hour (4:15pm - 5:15pm)			
	Heavy vehicles	Light vehicles	Heavy vehicles		Light vehicles		Heavy vehicles		Light vehicles	
Northcote Street civil site	100	150	Arrive 5	Depart 5	Arrive 50	Depart N/A	Arrive 5	Depart 5	Arrive N/A	Depart 150

Figure 9. Indicative construction vehicle movements at Northcote Street civil and tunnel site

Option B

If Option B is selected, the sites outlined below would be utilised. However, some work would still need to be undertaken below ground at the Wattle Street interchange.

In this case, there is potential to use the Wattle Street site outlined in Option A for tunnelling and tunnel support only.

The construction area at the surface between the Wattle Street carriageways would not be needed for M4-M5 Link construction purposes. This would be confirmed as part of detailed construction planning.

Parramatta Road West civil and tunnel site

This site would be located west of Parramatta Road between Alt Street and Bland Street at Ashfield.

The site would be used for tunnelling support during construction and would include temporary offices; an acoustic shed; a workshop and storage facilities; a temporary substation; temporary ventilation for the tunnels; a temporary water treatment plant; and car parking.

Key construction activities that would take place are outlined in Figure 11.

Roadheaders would be launched from this site and would excavate the temporary access tunnel, mainline tunnels and Wattle Street interchange entry and exit ramps.

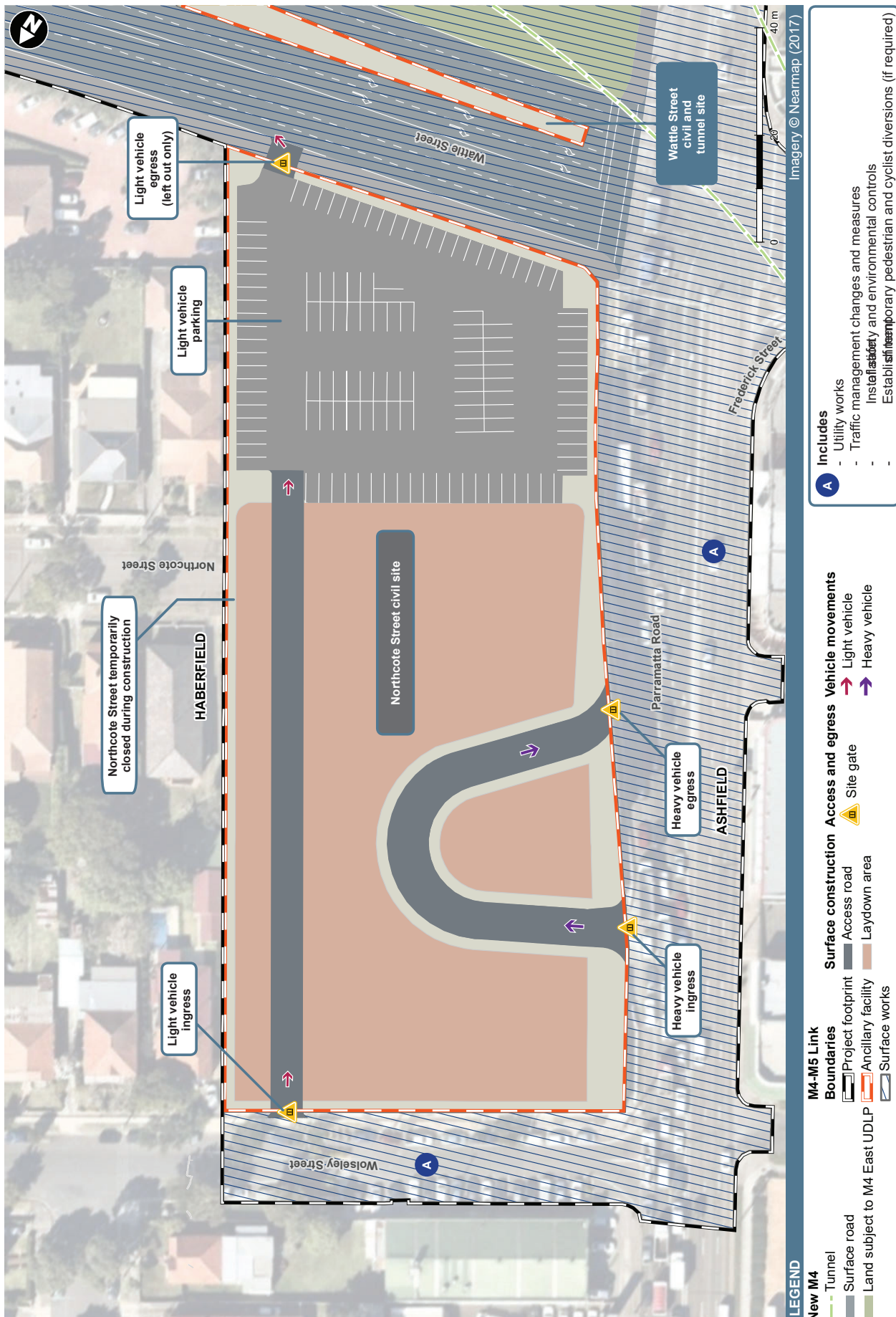

Figure 10. Indicative Northcote Street civil site layout

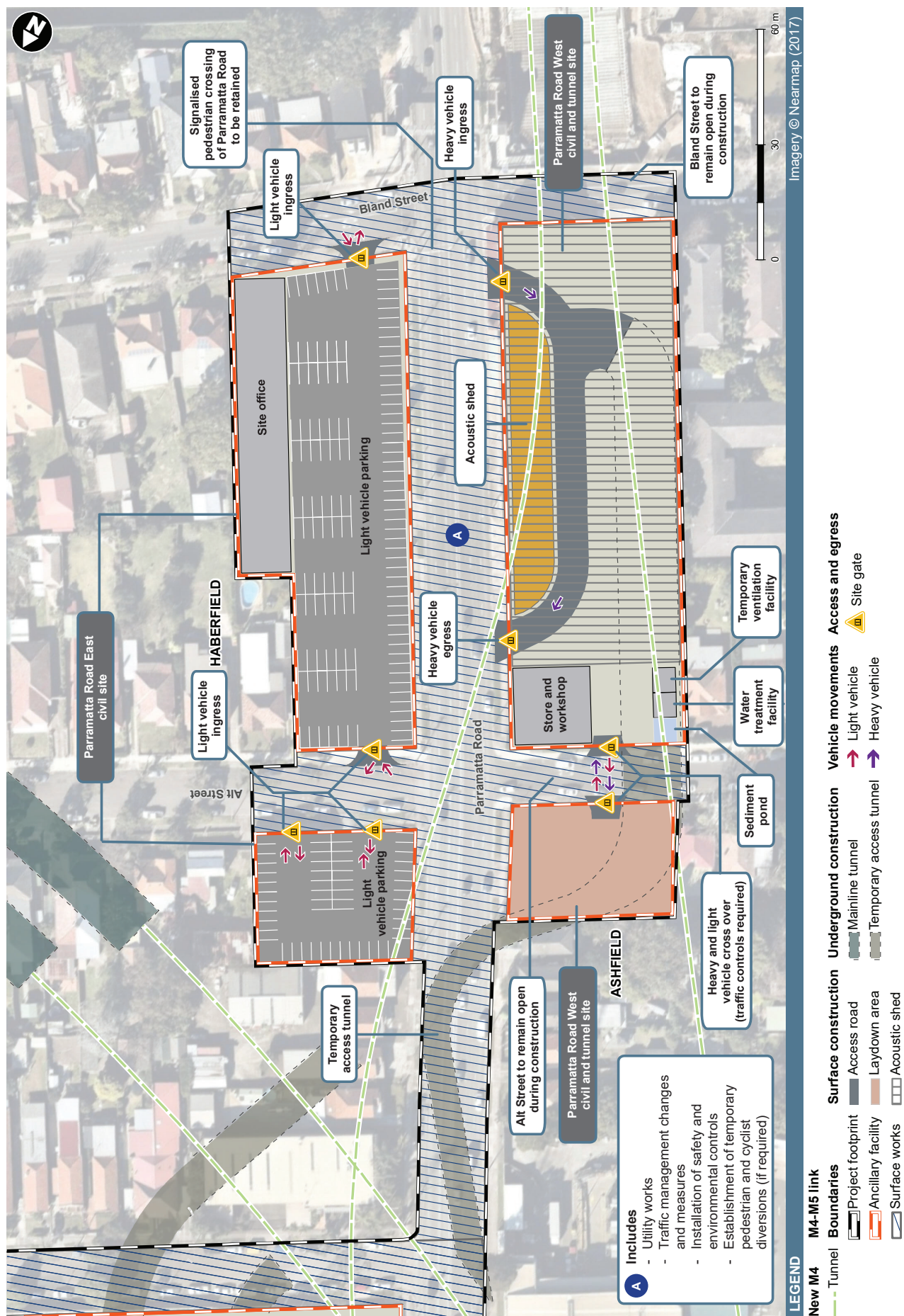

Figure 11. Indicative Parramatta Road West civil and tunnel site and Parramatta Road East civil site layout

Construction activity	Indicative construction timeframe																			
	2018				2019				2020				2021				2022			
	Q1	Q2	Q3	Q4	Q1	Q2	Q3	Q4	Q1	Q2	Q3	Q4	Q1	Q2	Q3	Q4	Q1	Q2	Q3	Q4
Site establishment and utility works																				
Construction of temporary access tunnel																				
Tunnelling																				
Civil and mechanical fitout																				
Testing and commissioning																				
Site rehabilitation																				

Figure 12. Parramatta Road West civil and tunnel site indicative construction program

Access routes

Construction traffic would enter and exit the site to and from the western (northbound) carriageway of Parramatta Road via new temporary driveways.

Vehicle movements

Location	Daily vehicles (one way)		AM peak hour (7:30am - 8:30am)				PM peak hour (4:15pm - 5:15pm)			
	Heavy vehicles	Light vehicles	Heavy vehicles		Light vehicles		Heavy vehicles		Light vehicles	
Parramatta Road West civil and tunnel site	140	10	Arrive 7	Depart 7	Arrive 10	Depart N/A	Arrive 7	Depart 7	Arrive N/A	Depart 10

Figure 13. Indicative construction vehicle movements at Parramatta Road West civil and tunnel site

Parramatta Road East civil site

This site is located east of Parramatta Road at Haberfield between Alt Street and Bland Street.

It would be used to support tunnelling construction activities at the Parramatta Road West civil site, and to provide construction workforce parking.

Key construction activities that would take place at this site are outlined in Figure 14.

Construction activity	Indicative construction timeframe																			
	2018				2019				2020				2021				2022			
	Q1	Q2	Q3	Q4	Q1	Q2	Q3	Q4	Q1	Q2	Q3	Q4	Q1	Q2	Q3	Q4	Q1	Q2	Q3	Q4
Site establishment and utility works																				
Use of car park and site amenities during construction																				
Demobilisation																				

Figure 14. Parramatta Road East civil site indicative construction program

Access routes

Light vehicles would enter and exit the site via Alt Street and Bland Street.

Vehicle movements

Location	Daily vehicles (one way)		AM peak hour (7:30am - 8:30am)				PM peak hour (4:15pm - 5:15pm)			
	Heavy vehicles	Light vehicles	Heavy vehicles		Light vehicles		Heavy vehicles		Light vehicles	
Parramatta Road East civil site	30	150	Arrive 3	Depart 3	Arrive 50	Depart N/A	Arrive 3	Depart 3	Arrive N/A	Depart 150

Figure 15. Indicative construction vehicle movements at Parramatta Road East civil site

Haberfield civil site

This site is an alternative design to the Haberfield civil and tunnel site outlined under Option A, but in the same location (by the south-eastern corner of the Parramatta Road and Wattle Street intersection, extending along Parramatta Road between Wattle Street and Walker Avenue).

The Haberfield civil site would predominantly be established to support fitout of the Parramatta Road ventilation facility (being built by the New M4 project) and construction of a substation. This civil site would not be used to support tunnelling.

Key construction activities that would take place at this site are outlined in Figure 16.

Construction activity	Indicative construction timeframe															
	2019				2020				2021				2022			
	Q1	Q2	Q3	Q4	Q1	Q2	Q3	Q4	Q1	Q2	Q3	Q4	Q1	Q2	Q3	Q4
Initial road works and traffic management																
Site establishment and utility works																
Fitout of Parramatta Road ventilation facility and substation																
Civil and mechanical fitout																
Testing and commissioning																
Site rehabilitation and landscaping																

Figure 16. Haberfield civil site indicative construction program

Access routes

Heavy vehicles delivering materials and equipment would enter and exit the Haberfield civil site via the westbound Wattle Street carriageways. Light vehicles would enter and leave the site via Wattle Street and Walker Avenue.

Vehicle movements

Location	Daily vehicles (one way)		AM peak hour (7:30am - 8:30am)				PM peak hour (4:15pm - 5:15pm)			
	Heavy vehicles	Light vehicles	Heavy vehicles		Light vehicles		Heavy vehicles		Light vehicles	
Haberfield civil site	10	20	Arrive 2	Depart 2	Arrive 10	Depart N/A	Arrive 2	Depart 2	Arrive N/A	Depart 10

Figure 17. Indicative construction vehicle movements at Haberfield civil site

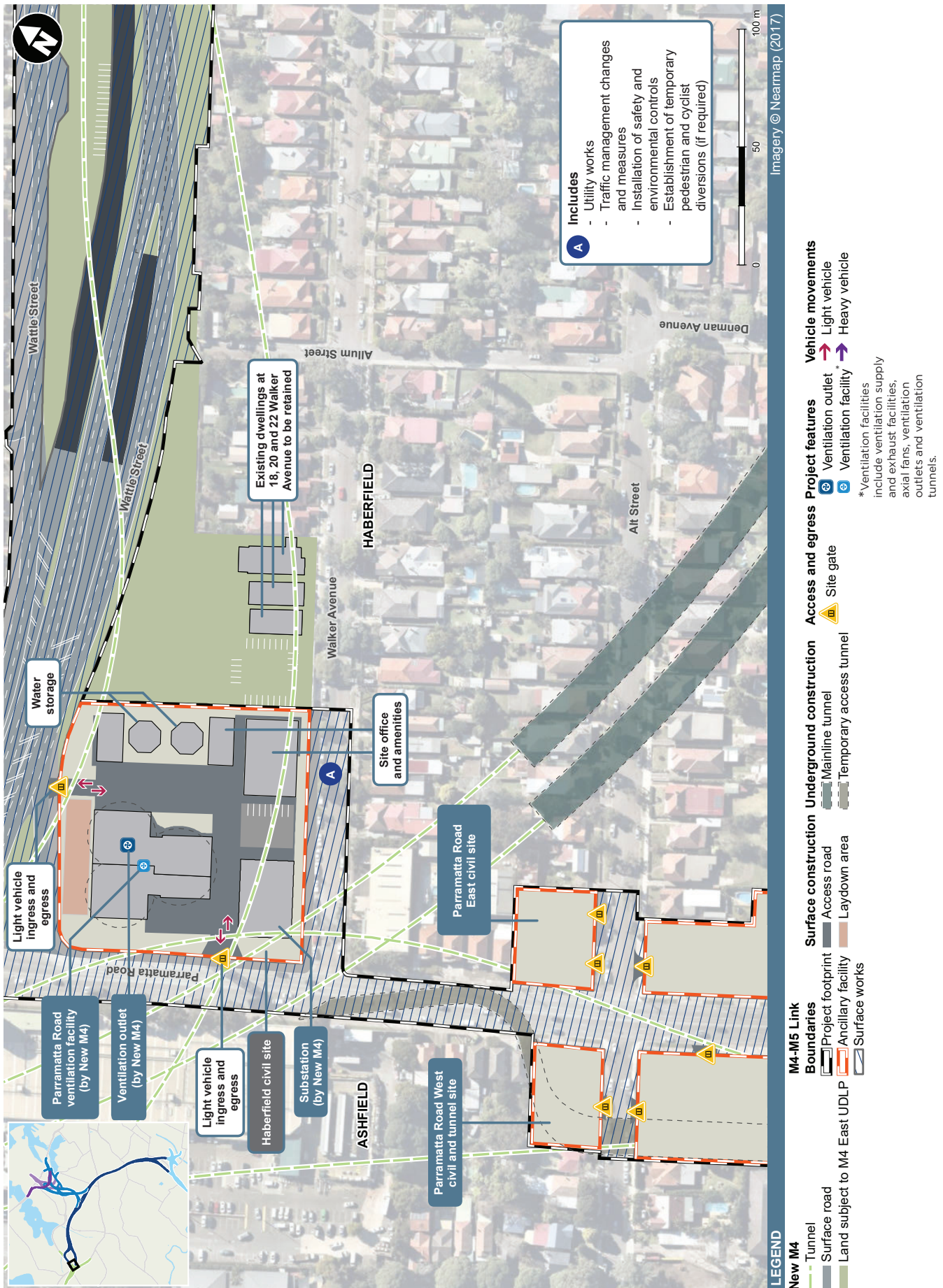

Figure 18. Indicative Haberfield civil site layout

Minimising impacts on the community

We are working to minimise the impact of construction on the community, with most of the proposed work to occur underground. However, some work would need to occur on the surface to construct the entry and exits to the tunnels and to build tunnel support facilities.

The M4-M5 Link Environmental Impact Statement outlines in detail the measures to mitigate any potential construction impacts.

Minimising noise

To minimise noise impacts during construction, several mitigation measures will be in place. These include:

- Providing noise barriers and an acoustic shed to house tunnelling activity
- Undertaking noisy work during standard work hours, where appropriate
- Ensuring all equipment is shut down when not in use and non-tonal reversing beepers used
- Ensuring there are periods where construction work is not scheduled to give residents respite.

Standard hours of work

Surface works

Above ground construction work would be carried out between the following standard construction hours:

- 7am to 6pm Monday to Friday
- 8am to 1pm Saturday
- Generally, no work on Sundays or public holidays
- Where work is required outside of these hours it would be conducted in accordance with conditions of approval and Environmental Protection Licence conditions.

Tunnelling work

Tunnelling work and support activities, including transporting excavated material, will take place up to 24 hours a day, seven days a week.

More information on tunnelling can be found in the M4-M5 Link - Tunnelling fact sheet at westconnex.com.au.

Future land use

An Urban Design and Landscape Plan (UDLP) will be developed for the M4-M5 Link, which will include detail on how the worksites will be rehabilitated following construction. Where there is a crossover between the New M4 and M4-M5 Link projects, commitments made as part of the New M4 UDLP will be delivered by the contractor appointed to deliver the M4-M5 Link.

Changes to traffic routes

We expect there would be minimal modifications to the road network or pedestrian and cyclist facilities for either construction support facilities option. Unless outlined below, alternative routes and diversions would be determined by the contractor in consultation with the council and community.

If Option A is selected, Northcote Street in Haberfield would be temporarily closed (for the duration of construction) at the intersection with Parramatta Road. Once construction is complete, the Northcote Street/Parramatta Road intersection would be reinstated.

At the Northcote Street civil site, there would be temporary closure of a section of footpath on both sides of Northcote Street. Alternative access for pedestrians to Parramatta Road would be provided via Ash Lane and either Wolseley Street or Wattle Street.

Protecting property

To provide peace-of-mind to local residents and businesses, all properties within 50 metres of the outer edge of the underground tunnels will be offered a property condition survey before construction, with a follow-up survey (for the property) after construction. This will ensure there is a clear record of the property's condition before and after construction. In the unlikely event there is any damage attributed to the project it would be repaired at no cost to the property owner.



Ramsay Street, Haberfield