

Weekend work and road closure on Campbell Road, Alexandria

Weekend work will be carried out to continue with the installation of Ausgrid, Sydney Water, Telstra and Optus services across Campbell Road. The work will take place at four locations on Campbell Road between Barwon Park Road and Harber Street as shown on the map provided overleaf. The work will involve trenching, excavation to install conduits for power, water and communications, backfilling and reinstating the roadway.

Timing and work hours

This work will take place on **Saturday 9 December and Sunday 10 December between 8am to 6pm each day**. This work is being conducted over the weekend when traffic volumes are lower for the safety for workers, motorists, cyclists and pedestrians.

Weekend road closure

The traffic changes will be in place from **Saturday 9 December from 8am until Sunday 10 December 6pm. Campbell Road between Barwon Park Road and Harber Street will be closed**. This is in addition to Campbell Street between Crown Street and Barwon Park road being closed for other works. Please note although there is no night work, the road will remain closed for the safety of motorists and pedestrians. Local access for residents as per the table below:

Crown Street residents	Crown Street entry will be via Barwon Park Road and exit via Campbell Street / Princes Highway. Traffic controllers will be in place to assist motorists and pedestrians.
Campbell Street residents	Campbell Street entry and exit via Barwon Park Road/Princes Highway.
Campbell Road residents	Campbell Road entry via Euston Road and exit via Burrows Road.
Barwon Park Road residents	Barwon Park Road entry and exit via Barwon Park Road/Princes Highway.

Traffic control and signage will be in place to assist motorists, pedestrians and cyclists through the changes. Pedestrian access to properties and along Campbell Street will be maintained at all times. Vehicle access to properties may be restricted at times. Please see the map overleaf for the locations of this work.

Equipment used

Excavators, dump trucks, concrete trucks, power tools, a plate compactor, traffic control, hand tools and light vehicles will be used to complete the work.

Minimising community impact

The work is expected to create some noise impacts to nearby residents. Every effort will be made to minimise noise associated with this work by:

- turning off equipment and vehicles when not in use
- using non-tonal reversing beepers on all machinery during work
- directing noise generating equipment away from residential properties where possible

During the works, pedestrian and cyclist access will be detoured away from the road closure and work zone. Traffic control will be in place to manage traffic impacts.

For more information

✉ info@newm5.com.au

☎ 1800 660 248

🌐 westconnex.com.au



Constructed by





Easing congestion



Creating jobs



Connecting communities

Traffic changes in place from Saturday 9 December 8am to Sunday 10 December 6pm

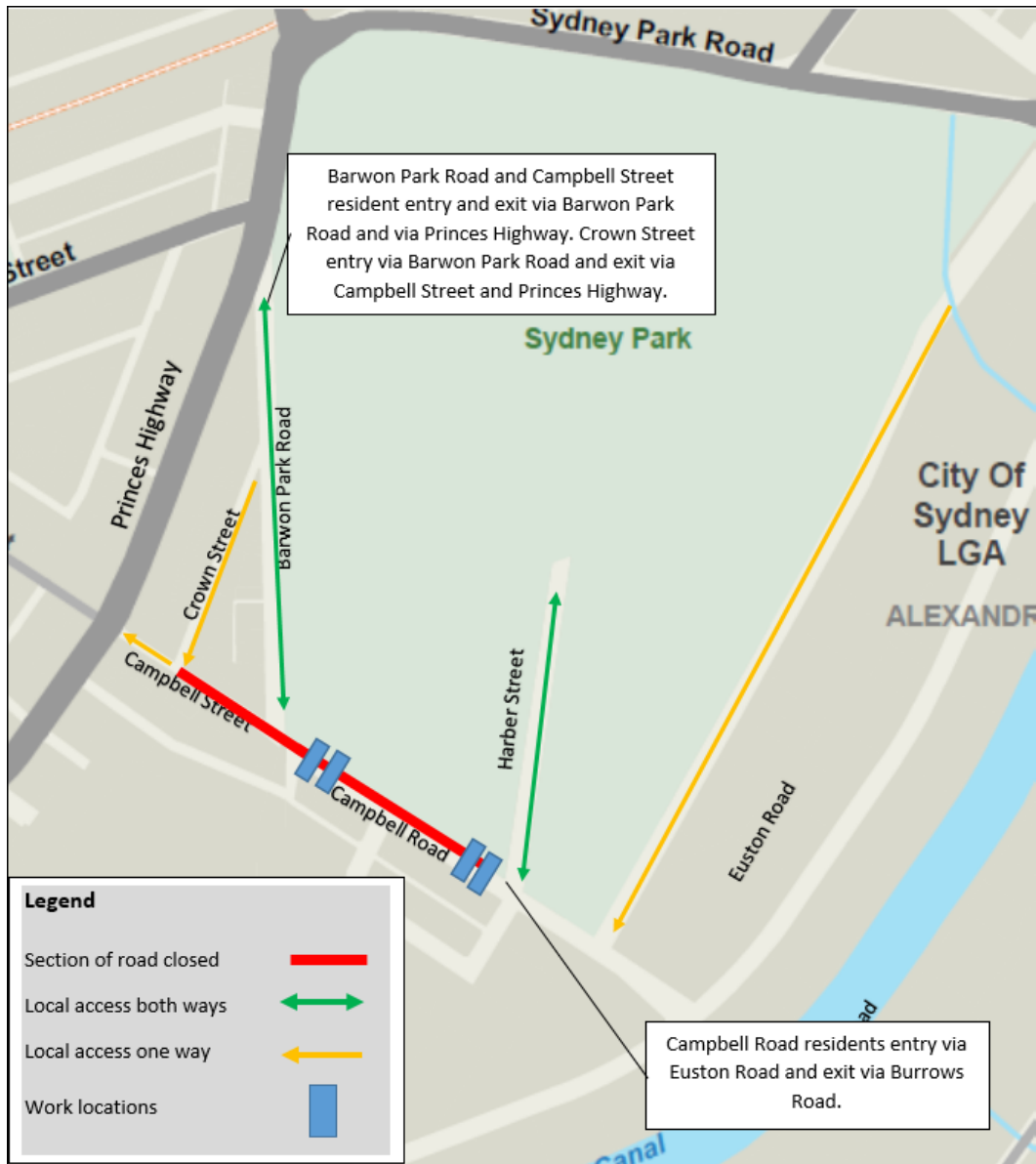

More information

If you have any questions about this work, please call 1800 660 248 and ask to speak to a member of the New M5 Community Engagement Team or email info@newm5.com.au. You can also visit the New M5 Community Information Centre located at 27 Burrows Road St Peters. The centre is open on weekdays from 9am to 5pm.

Notification No: 325



We speak your language

To learn more simply visit westconnex.com.au/yourlanguage. Need an interpreter? Call the Translating and Interpreting Service on 131 450